

EHV系列高压球阀

EHV Series High Pressure Ball Valve



Without Mounting Holes



With Mounting Holes

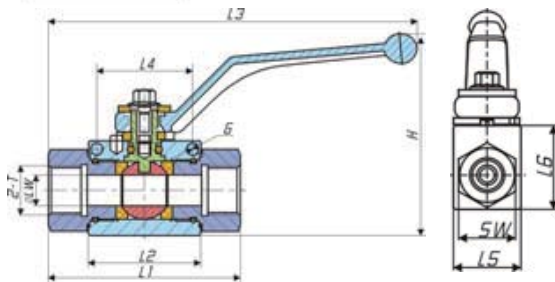

● Interchangeability(互换性): 可以与下列厂牌互换 PISTER BKH Series, MHA BKH Series, HYDAC KHB、KHM Series, CIOCCA, CRHI2 Series, GEMELS GE2 Series, HOLMBURY, HCV-2 Series

● Specifications(技术规范):

- Valve Size(口径): 1/4" ~1-1/2"
- Body (阀体): Carbon Steel, Stainless Steel
- Ball (球芯): Carbon Steel, Stainless Steel
- Seat (阀座): Delrin(POM)
- Handle (手柄): Zinc Alloy
- Standard O-Rings(标准密封圈): NBR,
- On request O-Rings: Viton(for high Temp.), HNBR(for low temp.) or other seals.
- Temperature Range (工作温度范围): -20°C to +120°C
- Working Pressure(工作压力): 315bar to 500bar
- Connection(连接方式): NPT, BSP(G) ----- etc.
- Surface Treatment(表面处理): Zinc plated (环保镀锌)
- Option(选用): with mounted hole 附安装口 (安装执行器)

Art.No.	Size	Max. Working Pressure	ΦLW	L1	L2	L3	H	G	L4	L5	L6	T
EHV14	1/4"	500 bar	Φ6	69	40	152	78	4.5	26	26	33	1/4BSPP(NPT)
EHV38	3/8"	500 bar	Φ10	71	42	154	84	5.2	32	33	38	3/8BSPP(NPT)
EHV12	1/2"	500 bar	Φ13	82	48	159	86	6.5	37.5	36	40	1/2BSPP(NPT)
EHV34	3/4"	315 bar	Φ20	96	62	219	19	6.5	45	49	57	3/4BSPP(NPT)
EHV10	1"	315 bar	Φ25	113	66	228	28	8.5	55	58	65	1BSPP(NPT)
EHV114	1-1/4"	315 bar	Φ25	120	66	231	28	8.5	55	58	65	1-1/4BSPP(NPT)
EHV112	1-1/2"	315 bar	Φ25	130	66	236	28	8.5	55	58	65	1-1/2BSPP(NPT)

Standard Type

Art.No.

DN(mm)LW(mm)

D

RA(mm)L(mm)i(mm)SW1(mm)

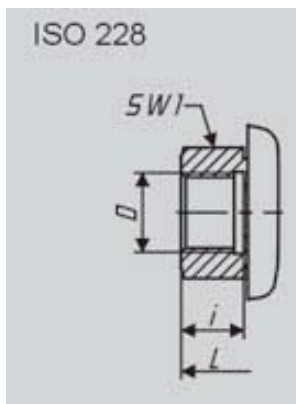

01

EHV-G1/4	6	6	G1/4	-	69	13.5	22
EHV-G3/8	10	10	G3/8	-	71	14	27
EHV-G1/2	13	13	G1/2	-	82	16.5	30
EHV-G3/4	20	20	G3/4	-	96	18	41
EHV-G1	25	25	G1	-	113	20	50
EHV-G1-1/4	32	25	G1-1/4	-	120	22	50
EHV-G1-1/2	40	25	G1-1/2	-	129	25	60

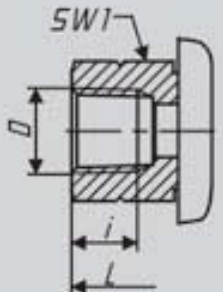
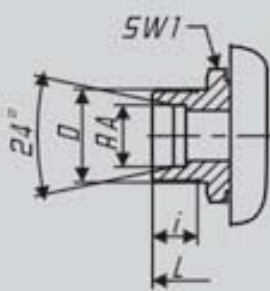
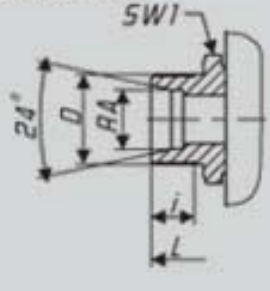
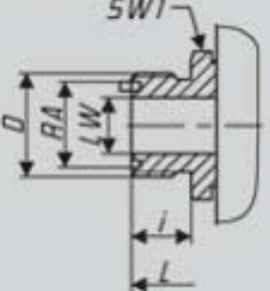
	Standard Type	Art.No.	DN(mm)	LW(mm)	D	RA(mm)	L(mm)	i(mm)	SW1(mm)
02	ANSI B 1.20.1 	EHV-1/4NPT	6	6	1/4-18NPT	-	76	11.5	22
		EHV-3/8NPT	10	10	3/8-18NPT	-	81	12	27
		EHV-1/2NPT	13	13	1/2-14NPT	-	102	15.5	30
		EHV-3/4NPT	20	20	3/4-14NPT	-	112	16	41
		EHV-1NPT	25	25	1-11.5NPT	-	122	19.5	50
		EHV-1-1/4NPT	32	25	1-1/4-11.5NPT	-	120	19.5	50
		EHV-1-1/2NPT	40	25	1-1/2-11.5NPT	-	129	19.5	60
03	ISO 8434-1 S 	EHV-10S	6	6	M18X1.5	10	73	9.5	22
		EHV-12S	8	8	M20X1.5	12	77	9.5	27
		EHV-16S	13	13	M24X1.5	16	87	11.5	30
		EHV-20S	16	13	M30X2	20	91	13.5	32
		EHV-25S	20	20	M36X2	25	111	15	41
		EHV-30S	25	25	M42X2	30	120	17	50
04	ISO 8434-1 L 	EHV-8L	6	6	M14X1.5	8	69	10	22
		EHV-10L	8	10	M16X1.5	10	77.3	11	27
		EHV-12L	10	10	M18X1.5	12	77.3	11	27
		EHV-15L	13	13	M22X1.5	15	83	12	30
		EHV-22L	20	20	M30X2	22	101	14	38
		EHV-28L	25	25	M36X2	28	108	14	44
05	JB/T966 	EHV-M16X1.5	6	6	M16X1.5	11.9	78	11	27
		EHV-M18X1.5	8	7	M18X1.5	13.1	82	11	27
		EHV-M22X1.5	10	10.5	M22X1.5	16.6	88	12	30
		EHV-M27X1.5	13	13	M27X1.5	20.4	91	13	32
		EHV-M36X2	20	20	M36X2	27	111	16	41
		EHV-M42X2	25	25	M42X2	32.4	126	20	50